

KEY NOTES

- 1 EXISTING FIRE ALARM DEVICE TO BE REINSTALLED INTO THE NEW CEILING.
2 NEW SPRINKLER RISER, 2 NEW TAMPER AND FLOW MONITORING MODULES AND MONITORING MODULE FOR PIV LOCATED NEAR BUILDING D. SEE THE SITE CIVIL PLAN FOR EXACT LOCATION.

NOTES:

1. CONTRACTOR TO INCLUDE AS PART OF THEIR BASE BID, THE RELOCATION OF UP TO 6 FIRE ALARM DEVICES PER BUILDING. THIS WILL BE TO ALLOW FOR MINOR RELOCATION OF FIRE ALARM DEVICES FOR COORDINATION WITH NEW SPRINKLER HEADS AND NEW LIGHT FIXTURES. ASSUME THE FIRE ALARM DEVICE MAY NEED TO BE SHIFTED TO AN ADJACENT TILE AND MAY REQUIRE REPLACEMENT OF THE EXISTING FLEX CONNECTIONS AND WIRING.

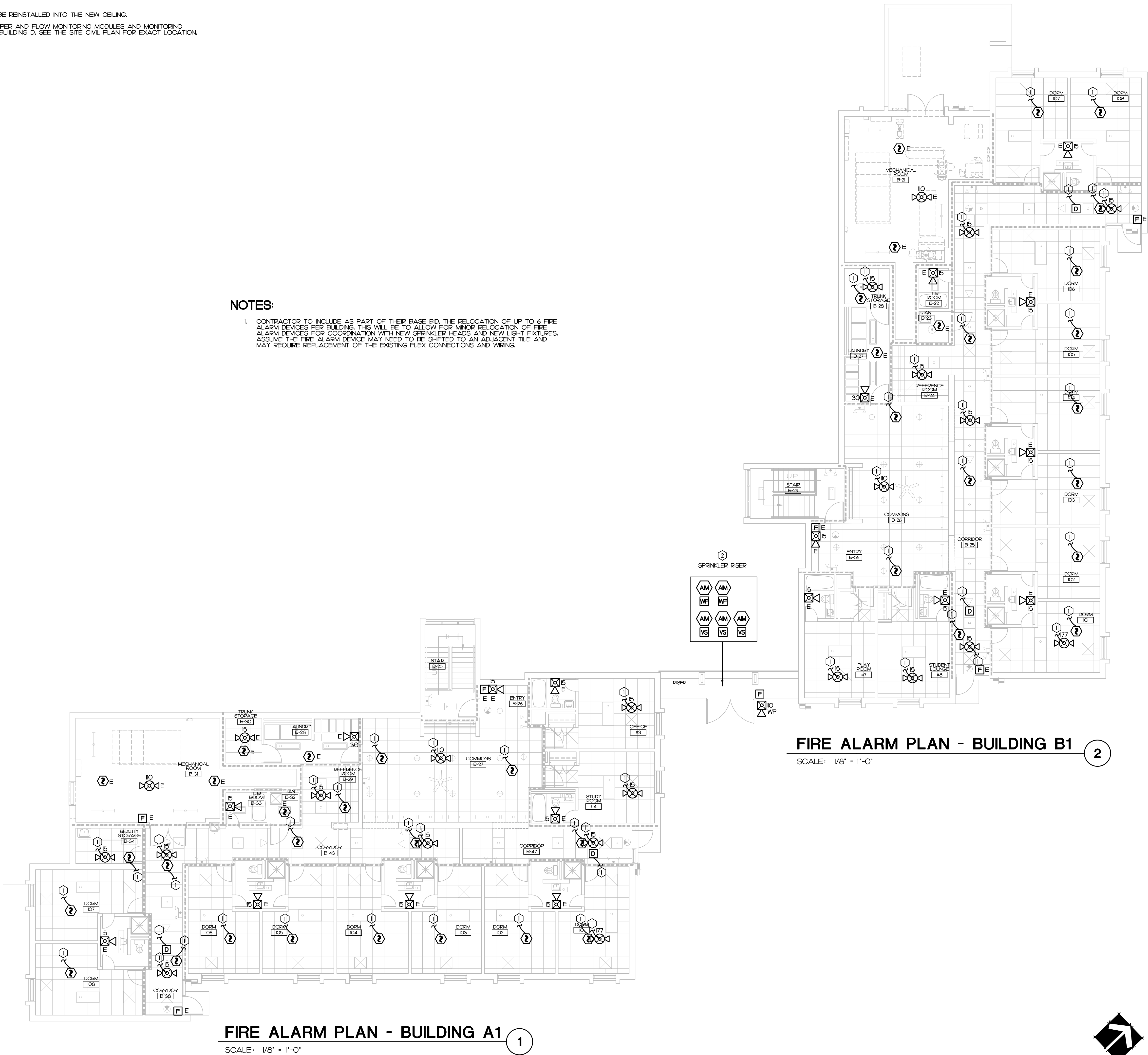

FIRE ALARM PLAN - BUILDING A1

SCALE: 1/8" = 1'-0"

1

FIRE ALARM PLAN - BUILDING B1

SCALE: 1/8" = 1'-0"

2

IMEG
3221 BLUE RIDGE ROAD, STE 113
RALEIGH, NC 27612
P: 919.571.1111
www.imegcorp.com
IMEG RESERVES PROPRIETARY RIGHTS, INCLUDING COPYRIGHTS, TO THIS DRAWING AND THE DATA SHOWN THEREON. SAID DRAWING AND/OR DATA ARE THE EXCLUSIVE PROPERTY OF IMEG AND SHALL NOT BE USED OR REPRODUCED FOR ANY OTHER PROJECT WITHOUT THE EXPRESS WRITTEN APPROVAL AND PARTICIPATION OF IMEG.
©2024 IMEG CONSULTANTS CORP.
North Carolina Design Registration #F-1507
PROJECT # 24048

REVISIONS	FOR CONSTRUCTION	5/27/25

ATLANTEC
ENGINEERS, PA
IMEG
3221 BLUE RIDGE ROAD, SUITE 113
RALEIGH, NC 27612
919.571.1111
24048

STATE OF NORTH CAROLINA
Professional Seal
DAVID J. WHITNEY
Engineer
No. 17382
5/27/25

PREPARED FOR:
NC DEPARTMENT OF INSTRUCTION
SCO #
24-27792-01A

GOVERNOR MOREHEAD SCHOOL
SPRINKLER, ADA TOILET, LIGHTING
UPGRADES FOR DORMS A, B, + D
RALEIGH, NC

CONTENTS:
BUILDING A,B FIRST FLOOR FIRE ALARM PLAN

DATE:
May 27, 2025

DESIGNER: **SWM**
ENGINEER: **DJW**

SHEET NO.
F-101
OF